

# AKTOBE REGION

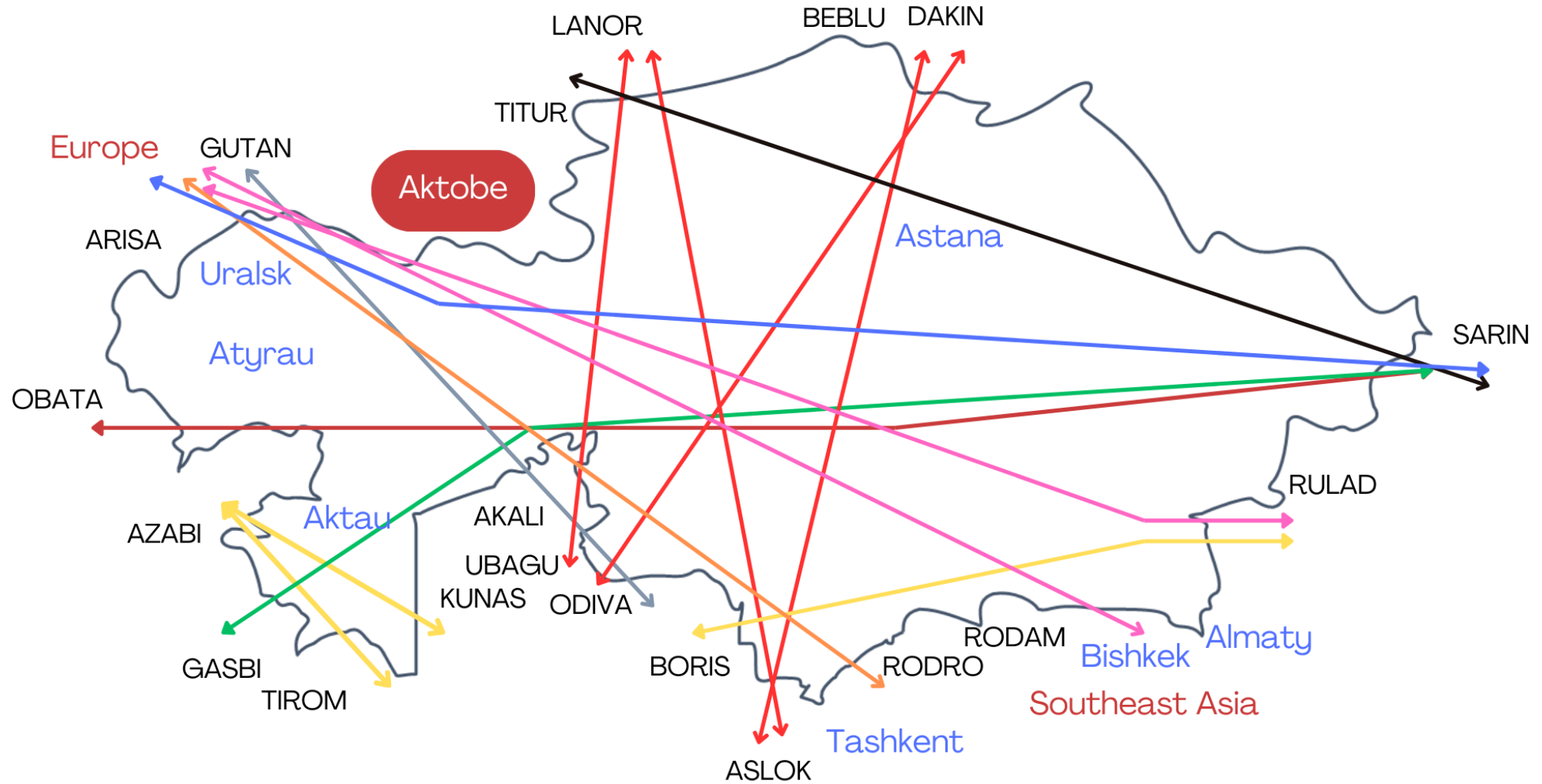

Aktolagai - Bayganinsky district, Aktobe region

# Transit advantage



# AKTOBE AIRPORT

## Aerodrome characteristics

Operating	24/7
Runway	3202x46 meters
Taxiways	3
Aircraft stands	16
Runway lights	CAT 1



# Aktobe Airport as a cargo HUB:

- 1 Modernization of the fuel complex, increasing its capacity and switching to JET-A1 fuel
- 2 Construction of modern warehouse infrastructure
- 3 Construction of a container terminal for the development of multimodal transportation
- 4 Creation of a special economic zone on the territory of the airport



ALIYA MOLDAGULOVA  
AIRPORT



**KMG AERO**

**OazPost**

**SSYSTEM**

# Aktobe Airport as a cargo HUB

## 1 Modernization of the fuel complex, increasing its capacity and switching to JET-A1 fuel

- Construction of a mobile refueling complex for the storage and delivery of aviation fuel to the apron with a storage capacity of up to 600 m<sup>3</sup>.
- Acquisition of airfield tankers in the amount of 2 units by the end of 2024. With a volume of 20 m<sup>3</sup> and 40 m<sup>3</sup>.
- Construction of a tank farm (tank farm) with a storage capacity of 20,200 m<sup>3</sup> of petroleum products of which:
  - RVS for storage of 12,200 m<sup>3</sup> of aviation fuel (aviation fuel TS-1/RT/Jet A1);
  - RVS for storage of 2,000 m<sup>3</sup> (Gasoline Ai-95);
  - RVS for storage of 2,000 m<sup>3</sup> (Gasoline Ai-92);
  - RVS for storage of 2,000 m<sup>3</sup> (DTL);
  - RVS for storage of 2,000 m<sup>3</sup> (DTZ -25°C).



# Aktobe Airport as a cargo HUB:

- 2 Construction of modern warehouse infrastructure
- 3 Construction of a container terminal for the development of multimodal transportation

## ▪ Multifunctional logistics hub:

The area is 10,000 sq.m.

Modern cargo handling system

High security measures

Handling of dangerous and radioactive cargoes

Cold storage rooms

Warehouse for valuable goods

## ▪ Multimodal transportation:

Indoor Distribution Center

Parking for waiting containers

Transshipment terminal, cargo storage and handling

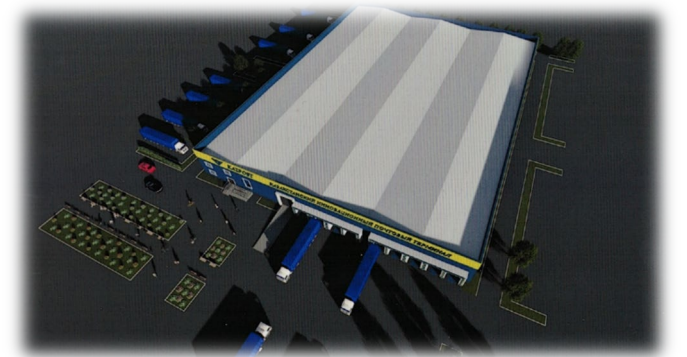

# Aktobe Airport as a cargo HUB:

## 4 Creation of a special economic zone on the territory of the airport

- The introduction of a special economic zone will contribute to attracting freight flows and, in general, to the development of transport infrastructure.
- Favorable conditions for business development will be created on the territory of the special economic zone, in particular, the provision of tax and customs preferences. A land plot of 858 hectares will be allocated for the special economic zone.



**THANK YOU!**

# Aktobe International Airport

[www.akx.kz](http://www.akx.kz)

[info@akx.kz](mailto:info@akx.kz)

